

**WELCOME TO THE**

**BRITISH  
CONFERENCE OF  
UNDERGRADUATE  
RESEARCH 2024**



**25 – 26 APRIL 2024**



**CHENG KIN KU BUILDING (CKK),  
54 LINCOLN'S INN FIELDS, WC2A 3LJ**



THE LONDON SCHOOL  
OF ECONOMICS AND  
POLITICAL SCIENCE ■

# WELCOME TO THE BRITISH CONFERENCE OF UNDERGRADUATE RESEARCH 2024

For more information about The Eden Centre, please scan the QR code or visit: [info.lse.ac.uk/staff/divisions/Eden-Centre/About-us](https://info.lse.ac.uk/staff/divisions/Eden-Centre/About-us)



Dear BCUR 2024 delegates, staff, guests and supporters,

**We are delighted to welcome you to the British Conference of Undergraduate Research 2024, the first BCUR taking place in London.**

The BCUR is an annual academic conference dedicated to showcasing and celebrating undergraduate research in the UK and encouraging students in their explorations across multiple disciplines. In the past 11 years, BCUR was hosted by 10 universities from the UK and 3,500 student delegates presented their research.

The London School of Economics and Political Science is delighted to be hosting this year's BCUR at the Cheng Kin Ku building. Our aim is to foster engaging conversations among a diverse cohort of multidisciplinary students and create a space where participants can deepen

their understanding, challenge previously held assumptions and learn from each other. We are excited to host about 350 student presentations over the next two days including a mix of oral presentations, posters and performances. We hope this conference sparks your curiosity and broadens your understanding of what undergraduate-led research looks like and what potential it has to benefit the wider society.

We are grateful to everyone who has made today's conference possible. Most of all, thank you to all of our conference participants who are sharing their research with us at BCUR 2024. Enjoy the conference!

With best wishes,

Dr Claire Gordon, David Faggiani and Hongli Liu,

BCUR 2024 Organisers/LSE  
Eden Centre for Education  
Enhancement

# BCUR 2024 WORKSHOP SESSIONS AT LSE

Click [here](#) to reserve your space on your chosen workshops. **Please note:** some lecture theatre locations may change due to expected attendance numbers.

## **UNDERGRADUATE RESEARCH: REACH A WIDER AUDIENCE WITH YOUR RESEARCH**

Presented by Ellie Potts from LSE Press

*Thursday 25 April at 2:50-3:40pm, in Wolfson Lecture Theatre.*

This workshop will discuss publishing as an undergraduate and how to choose and evaluate journals. LSE Houghton St Press and Grimshaw Review of International Affairs will be highlighted.

## **DIVERSIFYING YOUR THINKING: TOOLS AND TECHNIQUES FOR GETTING NEW IDEAS**

Presented by Giovanni Graglia from LSE LIFE

*Thursday 25 April at 2:50-3:40pm, in Thai Lecture Theatre*

This workshop will practice a variety of tools and techniques to think creatively and generate ideas and perspectives, whatever the topic.

## **LITERATURE SEARCHING FOR UNDERGRADUATES**

Presented by Kevin Wilson from LSE Library

*Thursday 25 April at 2:50-3:40pm, in Alumni Lecture Theatre*

This workshop will explain how to plan and develop a strong search strategy that can be used across various academic databases and search engines to find the most appropriate literature for your literature review.

## **USING SOCIAL MEDIA FOR EFFICIENT NETWORKING STRATEGIES**

Presented by Amy Fox from LSE Careers

*Thursday 25 April at 2:50-3:40pm, in Sheikh Zayed Lecture Theatre*

This workshop will equip you with effective strategies for utilizing social media to enhance networking skills and advance your academic and professional pursuits.

## **LIBRARY EXHIBITION GUIDED TOUR**

Presented by Daniel Payne from LSE Library

*Thursday 25 April 2:50-3:20pm and Friday 26 April 4:20-4:50pm, in LSE Library Gallery, Ground Floor*

This tour will include 15 minutes of talking on networks of solidarity between groups campaigning on peace, nuclear weapons and national self-determination, leaving time for participants to browse the exhibition. Each tour is capped at 20 people.

## **USING ARCHIVES FOR RESEARCH**

Presented by Maria Bell from LSE Library

*Friday 26 April 4:20-4:50pm, in LSE Library (TBC)*

This workshop will share strategies and tips on how to use archives and primary sources and ways to critically engage with them.

## **GETTING YOUR RESEARCH READY FOR REINVENTION**

Presented by Inés Robledo and Sol Xiaomeng Rodriguez Oliete from the University of Warwick

*Friday 26 April at 4:20-4:50pm, in Wolfson Lecture Theatre*

This workshop will explain what is Reinvention, how to tailor your research to ensure a successful submission, and what to expect in the publishing process.

## **MAKE RESEARCH ACCESSIBLE AND UNDERSTANDABLE FOR WIDER AUDIENCES**

Presented by Rosemary Deller from LSE Communications

*Friday 26 at 4:20-4:50pm, in Alumni Lecture Theatre, CKK Building*

This workshop aims to equip participants with the skills to communicate research findings effectively to diverse audiences, making complex topics accessible and understandable.

# KEY SPEAKERS



## DR JILLIAN TERRY

Dr Jillian Terry is Associate Professor (Education) and Co-Director of LSE100, the sector-leading flagship interdisciplinary course taken by all undergraduate students at the London School of Economics and Political Science. Trained as an International Relations scholar, Jillian's research foregrounds feminist ethical perspectives on violence and focuses on the role of new technologies in war and surveillance. She also works on scholarship of teaching and learning, with research interests in interdisciplinary education and inclusive pedagogies.

Jillian is an enthusiastic advocate for student research – during her time as a student at Memorial University (Canada), she founded the institution's first student-run academic journal, *Mapping Politics*. In 2021, she helped to establish LSE's interdisciplinary student research conference, *Knowledge Beyond Boundaries*.

This annual conference invites LSE students, recent alumni, and students from the CIVICA alliance to present their work in an interdisciplinary environment as part of the LSE Festival.



## PROFESSOR TIM LEUNIG

Professor Tim Leunig is a multiple-international prize-winning economist. He has taught at the LSE for 25 years, and at Oxford, and held visiting faculty positions in the US and Europe. He has worked for the UK government for over 10 years, including serving as economic adviser to two chancellors (Javid, Sunak), three housing secretaries (Clarke, Javid, Gove), and as chief analyst and chief scientific advisor at the Department for Education.

In government, he invented the UK furlough scheme during covid, saving more than 3 million jobs. He also invented the post-covid rent arbitration scheme, the schools national funding formula, and the method by which we assess the effectiveness of secondary schools, Progress 8. He is Director, Public First Consulting, and an Associate Member of Nuffield College, Oxford. He is a Fellow of the Academy of Social Sciences, the Royal Society of Arts, the Royal Historical Society and a Governor of the National Institute of Economic and Social Research.



## DR GRACE LORDAN

Dr Grace Lordan is the author of *Think Big*, the Director of The Inclusion Initiative and Associate Professor at the London School of Economics and Political Science. Grace is an economist, and is an expert on the determinants of individual success, labour markets and skills, the future of work and creating inclusive leaders.

Her research is focused on measuring the benefits of inclusion within and across firms, as well as designing interventions that level the playing field for under-represented talent within firms. Grace is an expert advisor to the UK government sitting on their skills and productivity board, is a member of the UK government's BEIS social mobility taskforce and is on the Women in Finance Charter's advisory board. Her academic writings have been published in top international journals and she has written for the *Financial Times*, *Fortune*, *Fast Company* and *Harvard Business Review*.

[www.gracelordan.com](http://www.gracelordan.com)

# EVENT SCHEDULE

## THURSDAY 25 APRIL 2024

### 9:30AM REGISTRATION + MORNING REFRESHMENTS

CKK Lower Ground Foyer

### 10AM WELCOME SPEECHES

Dr Claire Gordon (LSE Eden Centre), Professor Larry Kramer (LSE President and Vice-Chancellor), Professor Susana Mourato (LSE Vice President and Pro-Vice Chancellor for Research), James Relf (General Secretary, LSE Students' Union), David Faggiani and Hongli Liu (LSE Eden Centre) CKK Sheikh Zayed Lecture Theatre

### 10:40AM THINKING BIG BY THINKING DIFFERENTLY

Dr Grace Lordan – Associate Professor in Behavioural Science at LSE and Founding Director of The Inclusion Initiative CKK Sheikh Zayed Lecture Theatre

### 11:40AM ORAL PRESENTATIONS: SESSION 1

Rooms CKK 1.07, 1.09, 1.10, 1.14, 1.15, 1.18, 2.06, 2.08, 2.09, 2.13, 2.14, 2.16

Alumni Theatre, Wolfson Theatre, Thai Theatre

### 12:40PM POSTER EXHIBITION AND LUNCH BREAK

CKK Lower Ground Foyer

### 1:40PM ORAL PRESENTATIONS: SESSION 2

Rooms CKK 1.07, 1.09, 1.10, 1.14, 1.15, 1.18, 2.06, 2.08, 2.09, 2.13, 2.14, 2.16

Alumni Theatre, Wolfson Theatre, Thai Theatre

### 2:50PM WORKSHOPS

Undergraduate Research: Reach A Wider Audience With Your Research Wolfson Lecture Theatre

Literature Searching For Undergraduates Alumni Lecture Theatre

Library Exhibition: A Say in the End of the World: Solidarity and Nuclear Defence in the Cold War LSE Library Gallery

Diversifying Your Thinking – Tools and Techniques for Getting New Ideas Thai Lecture Theatre

Using Social Media for Efficient Networking Strategies Sheikh Zayed Lecture Theatre

### 3:50PM ORAL PRESENTATIONS: SESSION 3

Rooms CKK 1.07, 1.09, 1.10, 1.14, 1.15, 1.18, 2.06, 2.08, 2.09, 2.13, 2.14, 2.16

Alumni Theatre, Wolfson Theatre, Thai Theatre

### 4:50PM NETWORKING AND DRINKS RECEPTION

Lower Ground Floor

### 6 - 7:30PM WELCOME DINNER

Staff Dining Room and Staff Common Room, 5th floor of the Old Building

### SECOND FLOOR

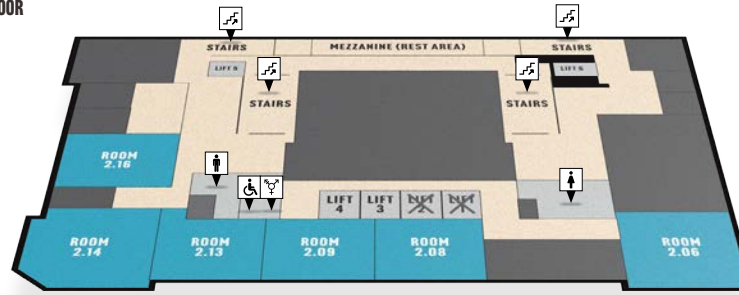

### FIRST FLOOR

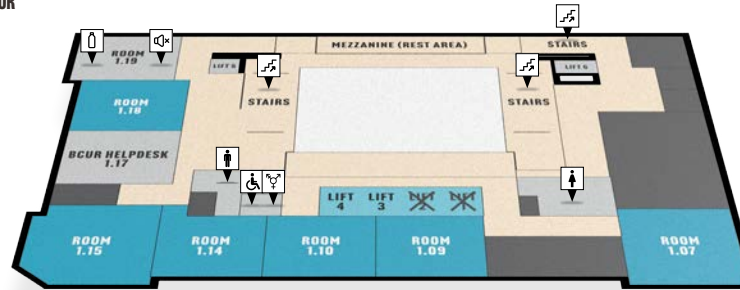

### GROUND FLOOR

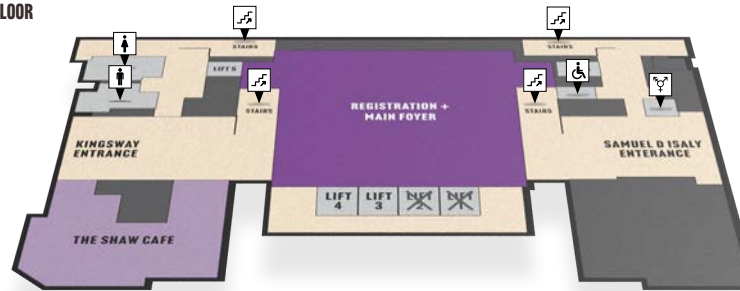

### LOWER GROUND FLOOR

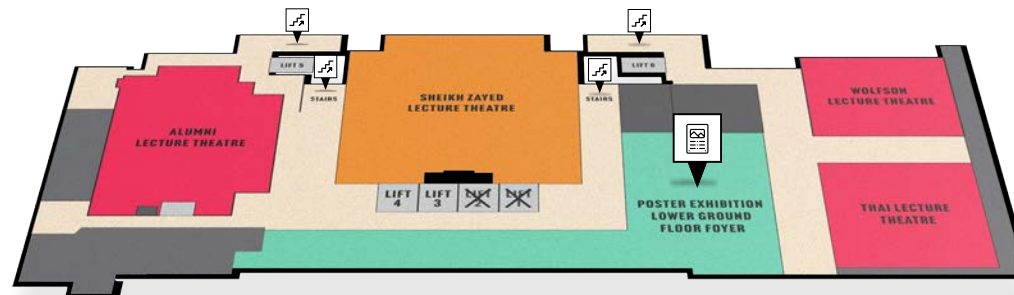

## FRIDAY 26 APRIL 2024

### 9:30AM REGISTRATION + MORNING REFRESHMENTS

CKK Lower Ground Foyer

### 10:00AM ORAL PRESENTATIONS: SESSION 4

Rooms CKK 1.07, 1.09, 1.10, 1.14, 1.15, 1.18, 2.06, 2.08, 2.09, 2.13, 2.14, 2.16

Alumni Theatre, Wolfson Theatre, Thai Theatre

### 11:10AM KEYNOTE SPEECH: BEYOND BOUNDARIES: THE POWER OF BECOMING INTERDISCIPLINARY

Dr Jillian Terry – Associate Professor (Education) and LSE100 Co-Director CKK Sheikh Zayed Lecture Theatre

### 12:10PM ORAL PRESENTATIONS: SESSION 5

Rooms CKK 1.07, 1.09, 1.10, 1.14, 1.15, 1.18, 2.06, 2.08, 2.09, 2.13, 2.14, 2.16

Alumni Theatre; Wolfson Theatre; Thai Theatre

### 1:10PM POSTER EXHIBITION AND LUNCH BREAK

CKK Lower Ground Foyer

### 2:10PM KEYNOTE SPEECH: ECONOMIC CHALLENGES FOR THE NEXT GENERATION

Professor Tim Leunig – Visiting Professor in Practice, School of Public Policy CKK Sheikh Zayed Lecture Theatre

### 3:10PM ORAL PRESENTATIONS: SESSION 6

Rooms CKK 1.07, 1.09, 1.10, 1.14, 1.15, 1.18, 2.06, 2.08, 2.09, 2.13, 2.14, 2.16

Alumni Theatre; Wolfson Theatre; Thai Theatre

### 4:20PM WORKSHOPS

Using Archives for Research LSE Library (TBC)

Getting Your Research Ready for Reinvention Wolfson Lecture Theatre

Library Exhibition: A Say in the End of the World: Solidarity and Nuclear Defence in the Cold War LSE Library Gallery

Make Research Accessible and Understandable for Wider Audiences Alumni Lecture Theatre

### 5:15 - 5:30PM CLOSING PLENARY DISCUSSION

Dr Claire Gordon (LSE Eden Centre), Professor Paul Taylor (Co-Chair of the BCUR Executive Group) CKK Sheikh Zayed Lecture Theatre

### KEY

- Men's toilet
- Women's toilet
- Quiet space
- Research poster exhibition
- Accessible toilet
- Gender neutral toilet
- Bottled water

Note: Use lifts 3 and 4 go to LG, Ground, 1st and 2nd floors. Lifts 1 and 2 only service floors 3-8

**NOW SHOWING**



## **LSE LIBRARY CURRENT EXHIBITION**

**A SAY IN THE END OF THE WORLD: SOLIDARITY AND  
NUCLEAR DEFENCE IN THE COLD WAR**

*Gallery, LSE Library, Ground floor*

Open daily to public – delegates can view this at any  
time from 9am – 6pm.

## **BCUR ADMIN TEAM**

We are here to help you. If you see us, please come  
and say hi.



**DR CLAIRE GORDON**

Director, LSE Eden Centre



**DAVID FAGGIANI**

LSE Eden Centre Comms  
& Digital Manager

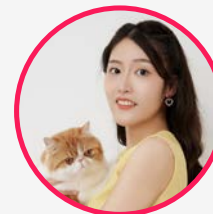



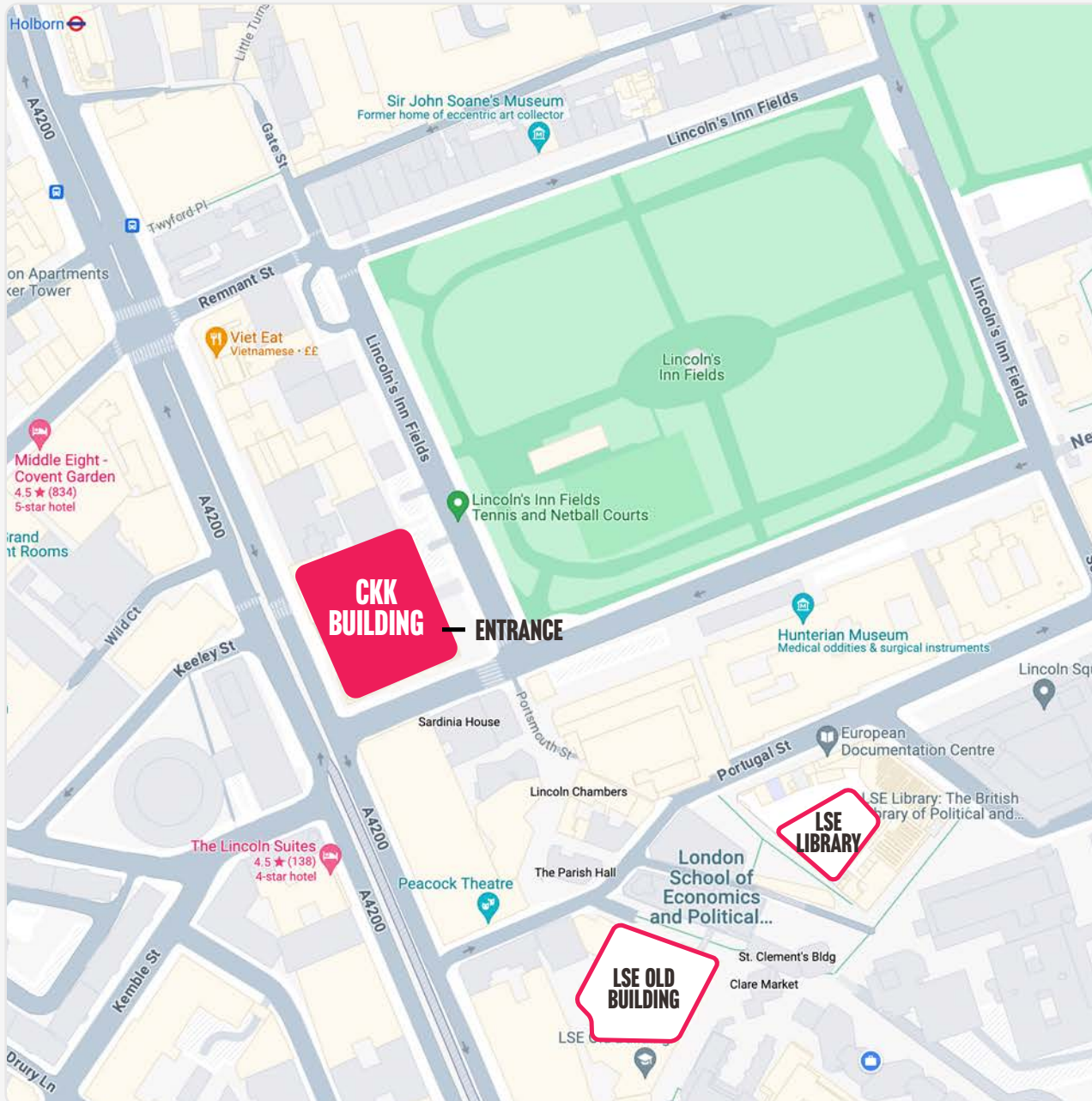

**HONGLI LIU**

LSE Eden Centre BCUR Administrator



## NEAREST STATIONS

- 
**Holborn station**  
 (5 min walk)
- 
**Charing Cross station**  
 (11 min walk)
- 
**Bus stop M (Kingsway)**  
 (4 min walk)  
 1, 59, 68, 91, 188, 243
- 
**Bus stop H (Aldwych Bush House)**  
 (4 min walk)  
 9, 23, 87