

Firoz Lalji Global Hub

The London School of Economics' new Firoz Lalji Global Hub is an historic opportunity. It will not only allow Britain's most prestigious international institution to expand its academic facilities and complete its University Quarter, but with its architecture, it can express the economic, environmental and cultural significance of the Global South. Our proposal is therefore inspired by the particular forms, materials, patterns and ideas attributed to pre-colonial African cultures and their universally recognizable qualities that resonate across all cultures and geographies.

These references include the clustered circular Mousgoum settlements of Cameroon, West Africa's majestic Hausa architecture and the distinctive geometric patterns that occur in the myriad art and craft traditions of Africa's diverse nations. These readings underpin our primary urban approach: subtly curved symmetrical facades that embrace their context; sculpted terra cotta cladding that echo clay-based architectural traditions, and a stepped massing, emphasizing rootedness and heft.

We have embraced traditional patterns of gathering and exchange with our radiant elliptical Agora, circular plan geometries and a carefully considered natural material palette. Our Firoz Lalji Global Hub design will therefore embody principles and philosophies not typically represented in European architecture. It will celebrate these principles on the civic stage that is the LSE Quarter and Lincoln's Inn Fields.

Intwoven with the scale and grain of its European neighbours and demonstrating the highest levels of sustainability for its type, the Firoz Lalji Global Hub will act as a significant architectural emblem for the London School of Economics. It will signal the LSE's inclusive values and commitment to diversity with an architecture redolent of the Global South. Our robustly structured and permeable Agora acts as a form of 'civic pedestal' supporting the Hub's communities of cross-disciplinary researchers, incentivizing public debate, and supporting the LSE critical role in addressing global challenges.



Wind Catchers, Yazd, Iran



Mousgoum Tolek, Cameroon



Traditional Hausa architecture

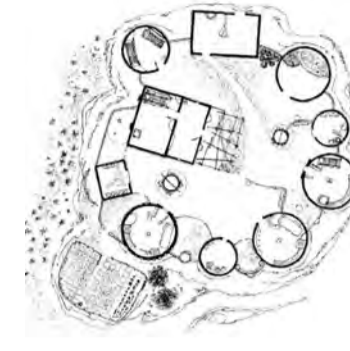
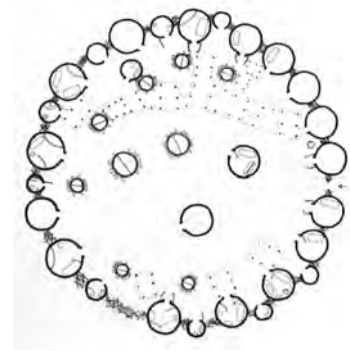

Musgum traditional homesteads, West Africa

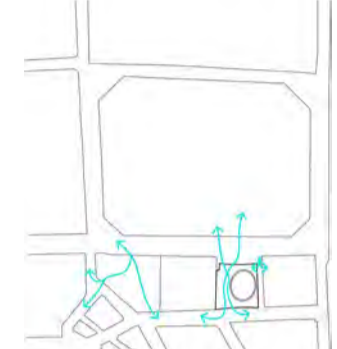

Opening & Connecting the Quarter



Extending the 'Fields'

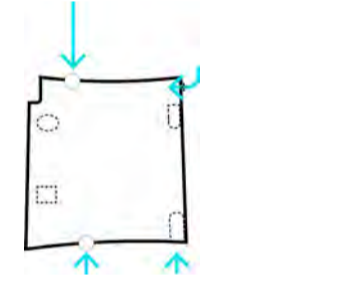

Access

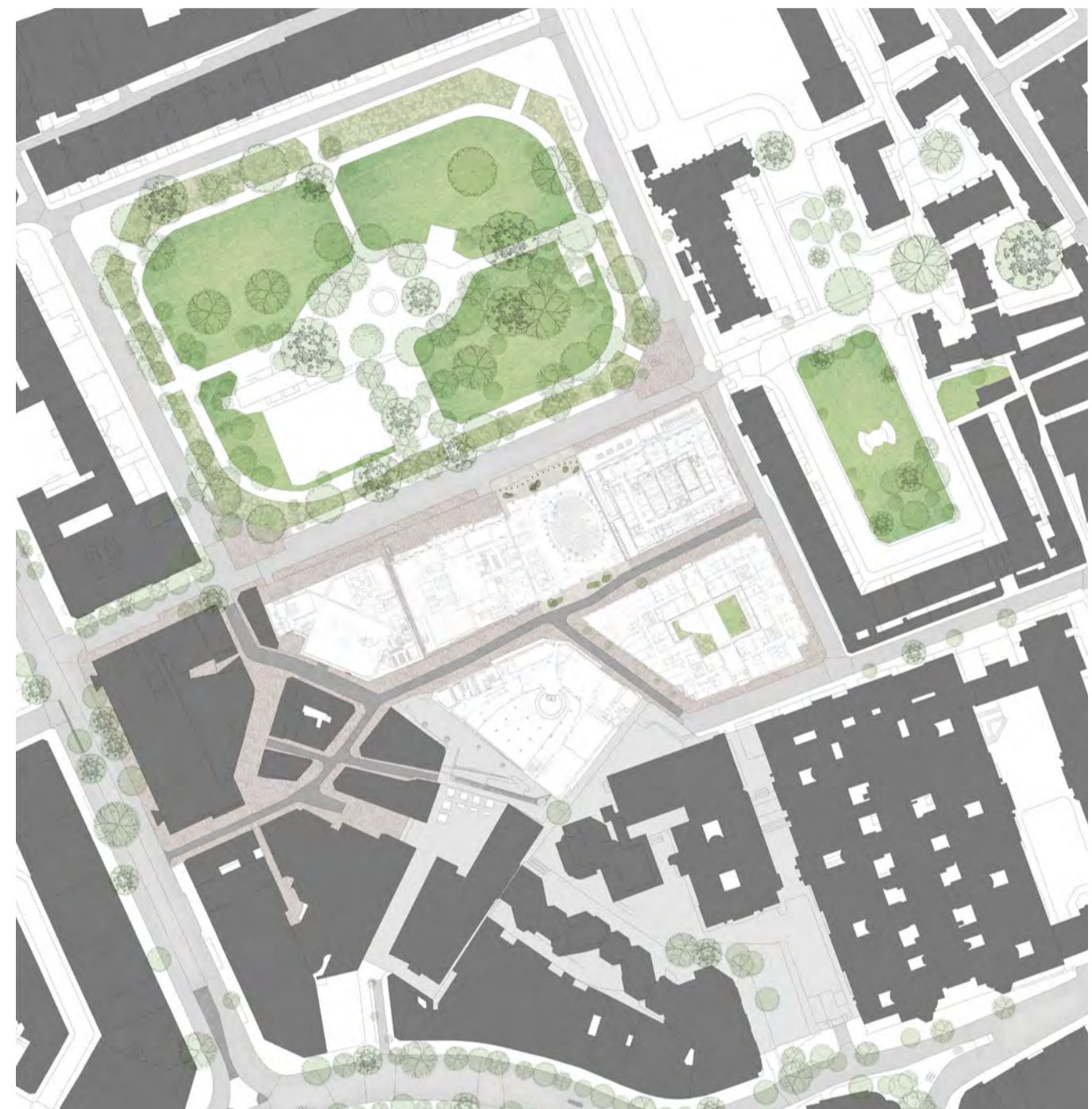

Urban Quarter Plan



Urban Approach

We have conceived the Firoz Lalji Global Hub's urban role as a conceptual and physical bridge between Lincoln's Inn Fields and the LSE campus. Its Ground Floor is a new 'public realm' connecting Portugal Street with Lincoln's Inn Fields. At 6.8m high, fully accessible and transparent, it will serve as a gathering space for the 300 seat Agora and threshold to the academic departments above. A foyer mezzanine alongside Portugal Street will offer panoramic study space and a viewing gallery for Foyer events. The important Portugal Street campus entrance will serve the majority of the Global Hub's users. It will be announced by a widening pavement, new trees and low planting. Our greening of Portugal Street and the campus Quarter will extend to the interstitial passage leading to 32 Lincoln's Inn Fields.

View upon entry



The Agora

