

The Agora

The elliptical Agora is the Firoz Lalji Global Hub's epicentre. We have conceived it as both a legible object, a structural frame and a significant auditorium designed to accommodate public, academic and professional audiences. A new type of civic auditorium, it will represent the highest spatial and technical calibre. It's elliptical plan form is inspired by traditions of circular gathering spaces, geometrically refined as a recessed amphitheatre. Concentric raked seating offers an optimal audience experience for both physical and digital presentations.

The Agora is defined externally as a radiating structure of fin-like columns. Internally, beams radiate from each fin toward a central oculus. Rather than walls, this finned perimeter allows the Agora to be read as an 'open form' visible from the street and from adjacent foyer spaces. Closeable doors between the fins allow the Agora to be sealed, visually and acoustically. The oculus will allow zenithal light to animate an uplifting new space of human exchange, learning and debate.

The Agora is sub-divisible into two teaching spaces using thick acoustic curtains with a central space for acoustic dampening. These curtains follow the curvilinear tracks expressed in the Agora's ceiling and the staggered seating plan to allow the Agora's side screens to operate independently as separate lecture venues. The Agora's perimeter offers an adaptable, layered structure to allow different modes of operation: It can be spatially open and accessible; acoustically sealed yet visible; or fully enclosed and private.

1:250 SITE PLAN

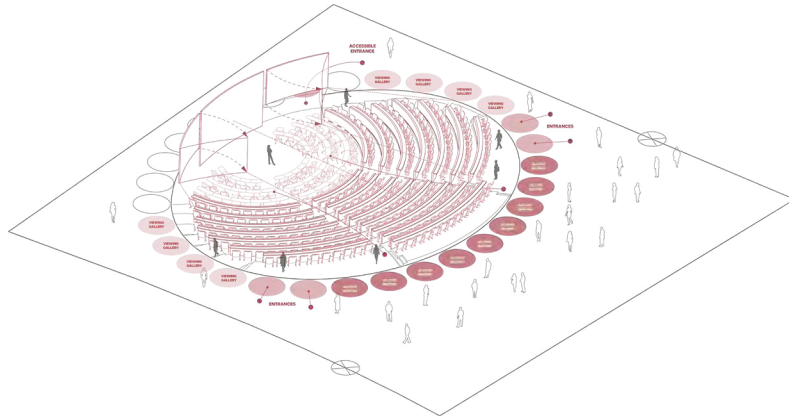

Defining the space with circles, access, seating arrangement, screens

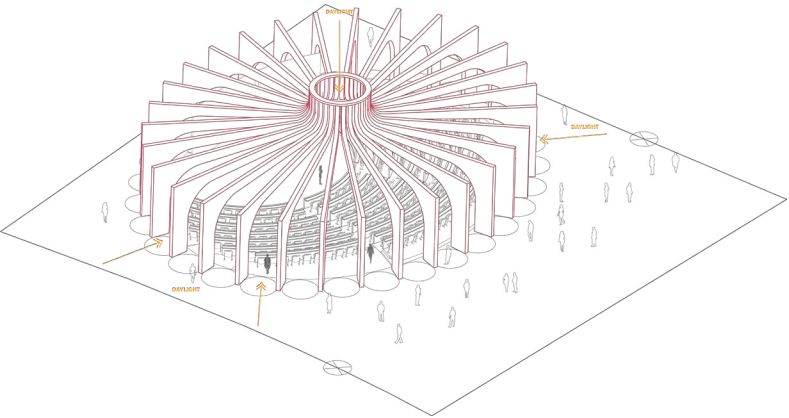

Structural array, oculus lift natural light

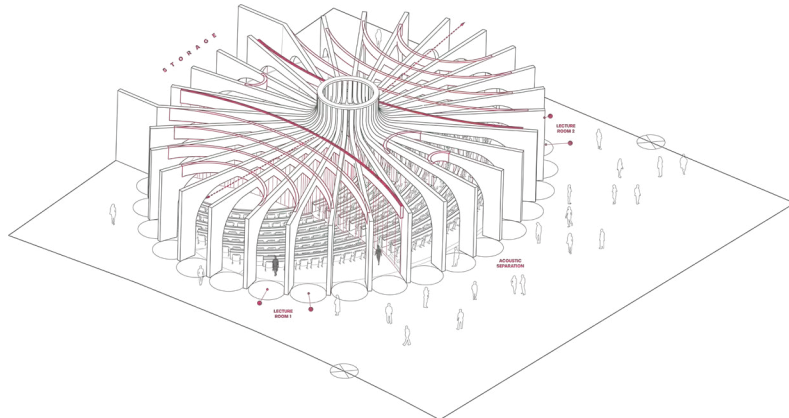

Curtain beams, room divisibility, curtain and storage

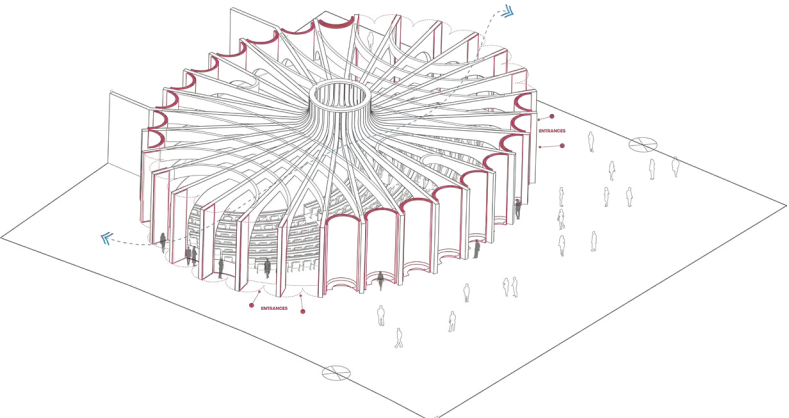

Alcoves, balconies, doors, natural ventilation

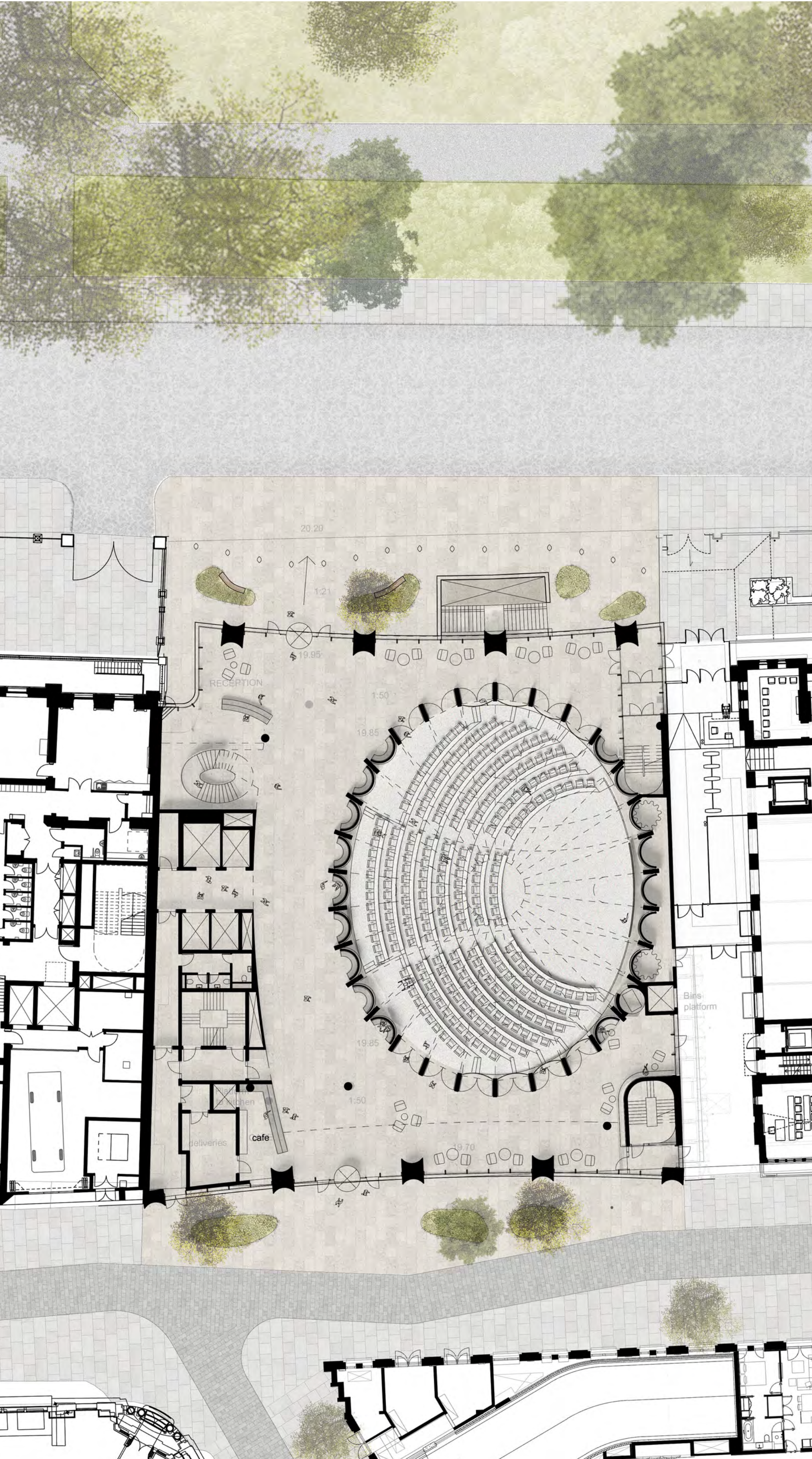

Subdivided Agora teaching space



Subdivided Agora teaching space

Transparency from Portugal Street to Lincoln's Inn Fields



The Agora



Niches line the Agora's exterior to create intimate spaces for informal working or socializing. These niches are expressed internally in the Agora as fluted timber acoustic panels between each structural fin. At the Agora's north and south ends, the fins allow full transparency, with the space between each fin acting as a small balcony; a public viewing gallery. Glazed doors will allow visitors to observe the Agora's activities. A further layer of separation and light reduction is achieved by an encircling Foyer Curtain. Made of natural materials, the curtain will celebrate the tradition of textile design from a chosen African designer.

Niches line the Agora's exterior to create intimate spaces for informal working or socializing. These niches are expressed internally in the Agora as fluted timber acoustic panels between each structural fin. At the Agora's north and south ends, the fins allow full transparency into the Agora, with the space between each fin will acting as a balcony or public viewing gallery. To acoustically separate the Agora from the Foyer, glazed doors will allow visitors to observe the Agora's activities. A further layer of separation and light reduction is achieved by a great Foyer Curtain that encircles the Agora. This curtain can be made of natural materials, its distinctive pattern and weave celebrating the art and craft of African textile design.