

Global Hub

Bringing the world to LSE

The global challenges of the last two years have brought many of us together through a shared experience of physical isolation and virtual connection. While we have embraced and enjoyed new technologies, we have also become more aware of the value of physical space and sharing it with others. In this sense, the new Firoz Lalji Global Hub, through the perceptive idea of a physical agora as its critical spatial energiser, can play a defining role in the future of debate, learning and understanding.

In their built form, educational institutions not only accommodate vital spaces for instruction and research, they also project important societal values and provide a shared collective experience of education, culture, and community for their students, staff and visitors alike.

The new Global Hub will become a symbol of environmental and social responsibility through the intelligent reuse and reinterpretation of the existing building. Through minimal and selective deconstruction it will unlock the potential of the original structure to shape a new building that is expressive, efficient and enduring.

The new building will not only become a singular physical platform for an exclusive audience, but its adaptability will provide LSE with multiple possibilities to host concurrent events, gatherings, promoting exploration and learning that can be shared physically and virtually. Spaces of diverse identity will enhance communication, debate and encourage exchange between LSE and the world. The prominent position of the Firoz Lalji Institute for Africa and the distribution of its exhibitions throughout its central space will provide a further platform for a wide range of voices to be heard.

In this sense, the whole building becomes an uplifting and regenerative agora, a singular yet complex place to convene, debate, exchange and learn between the diverse activities of the campus and shape responses to the issues of today and tomorrow.

The new building will support the development of LSE's own campus and affirm the institution's connection with Lincoln's Inn Fields and the wider neighbourhood. It will reinforce its place as a leader on the world stage through a proactive mission directed towards decarbonisation, climate emergency and social justice.

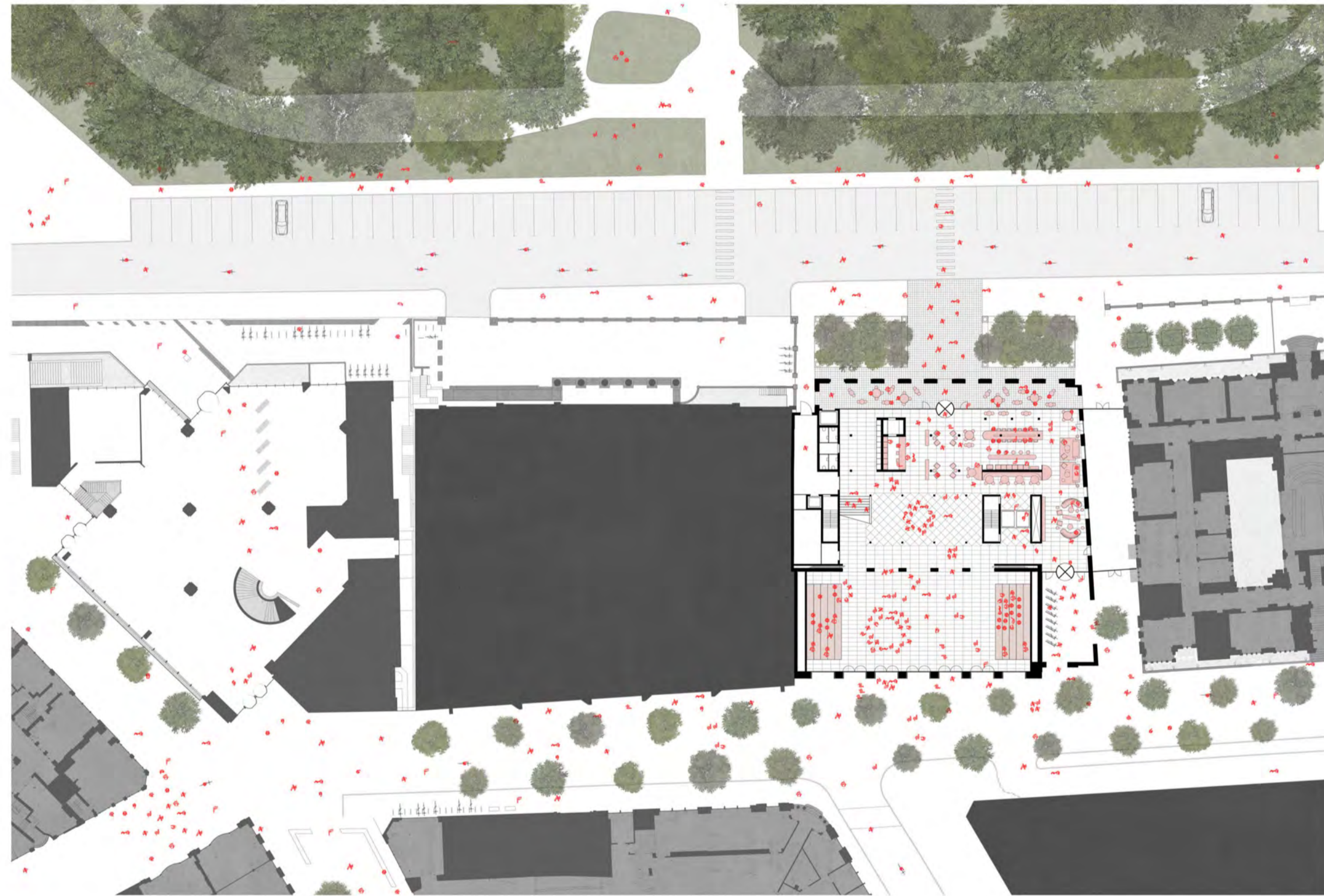

Ground floor plan with public realm

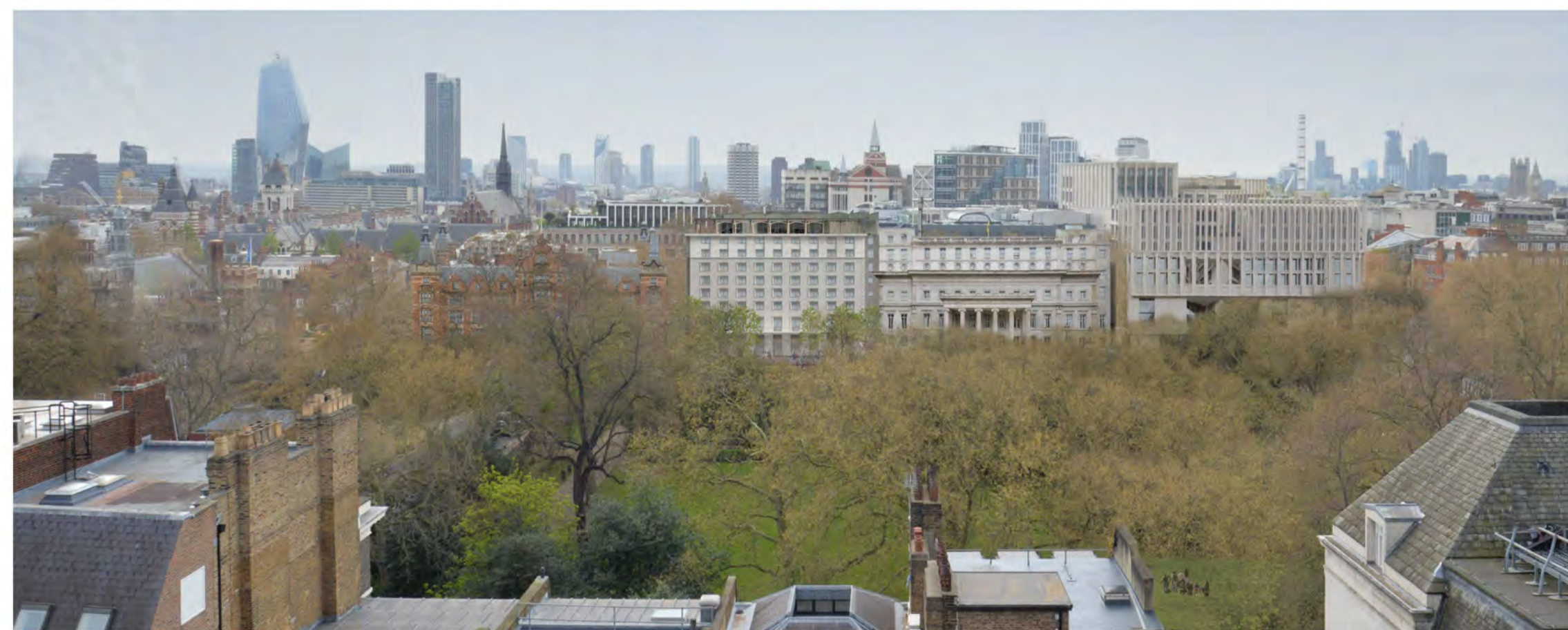

View looking south over Lincoln's Inn Fields



View looking west showing entrance forecourt, extended facade and new rooftop pavilion. Appearing a civic palazzo, the building opens out to LIF and strengthens the presence of LSE in the city.



Lincoln's Inn Fields elevation showing framing of Royal College of Surgeons