

Issue 8

14 November 2024



LONDON SCHOOL OF ECONOMICS AND POLITICAL SCIENCE

The Old Building Refurbishment & Electrification Newsletter

Dear Colleagues,

This newsletter provides an update on the Old Building Refurbishment & Electrification project and associated service shut-downs and mitigation measures.

Inside this issue:

Refurbishment works Level 1 to 6	1
Lift installations	2

Estates Division

Old Building Refurbishment Project

Refurbishment works Level 1 to 6

The refurbishment works Level 1 to 6 have now been completed.

The Department of Sociology moved into their new premises in July 2024 and Social Policy moved in September 2024.

Four new teaching rooms have also been created on the 1st floor and they will be available for use from January 2025.

The refurbishment has included the replacement of structure cabling throughout the building and the replacement of fire alarm services from level 1 to 6.

Below are some images of the newly refurbished spaces:

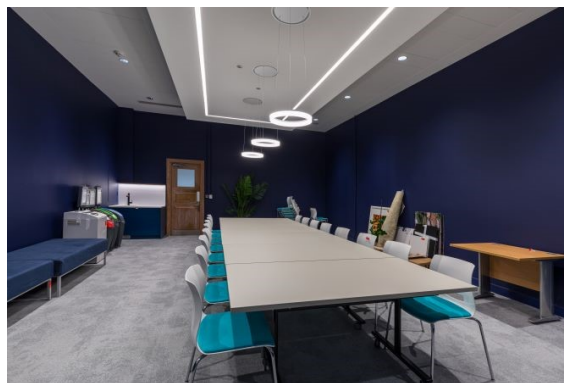

Social Policy meeting room

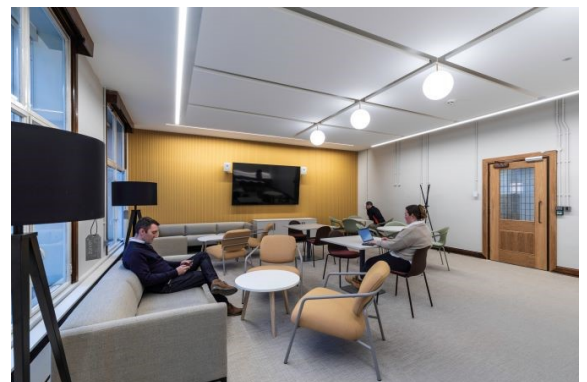

Level 3 common room



Level 4 PhD study room

Installation of Atrium Lift

In order to improve the accessibility of Level 1 and 2 a new platform lift will be installed in the Student Services centre. This lift will enable wheelchair users to access Level 1 and 2. The Atrium lift works are scheduled to start in January 2024 and complete by April 2024. An indicative illustration of the lift can be seen in this image.



Atrium Lift - planned completion Apr 25.



Selected lift model

Installation of Vera Anstey Room Platform Lift

A new platform lift will be installed in order to access the Vera Anstey Room on Level 1. The works are planned to start in January 2025 and complete by April 2025. This will enable wheel chair users to attend meetings in this meeting room.

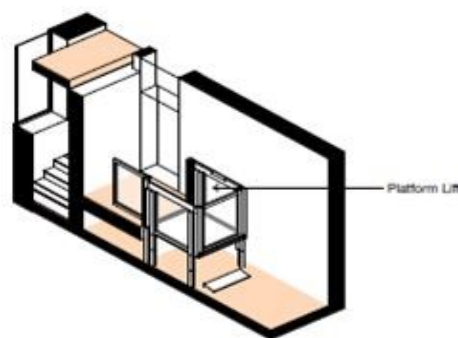

Vera Anstey Room Platform Lift—planned completion Apr 25.

Reporting Issues

If staff or students find any spaces that are cold, facilities that have no hot water or any building damage please report this via the Estates Helpdesk at Estates-Help-Desk@lse.ac.uk and the team will aim to prioritise these areas.

If you have any queries about the upcoming works please contact:
Francesco Biancelli— Principal Project Manager: f.biancelli@lse.ac.uk
Kenneth Kinsella—Director of Capital Development: k.kinsella@lse.ac.uk



Yours sincerely

K Kinsella

Director of Capital Development