

Issue 1

March 2025



LONDON SCHOOL OF ECONOMICS AND POLITICAL SCIENCE

Capital Development Project Newsletter

## **LSE** Estates Division Capital Development

### Dear Colleagues,

This newsletter provides an update on a variety of projects currently being undertaken by the Capital Development team in the Estates Division.

### Inside this issue:

CBG underpass closure	1
MAR fire safety work	1
CON/STC Asbestos Removal	1
New lifts in OLD	2
Firoz Lalji Global Hub at 35L	2
Public Sector Decarbonisation Scheme LRB	3
Volunteer Centre, Lincoln Chamber	3
King's Chambers Student Salon & Finial	4
Café 54—K54 rebrand	4
LRB turnstile upgrade	4

### Signage installation—Centre Building underpass

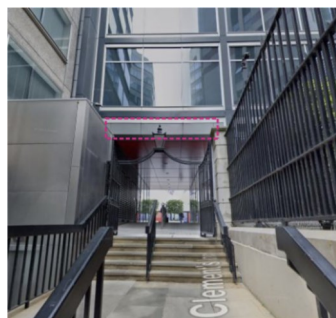

New LSE logo and letter signage will be installed on the CBG underpass facing Clement's Inn on **Monday 7 April 2025**.

The staircase and lift connecting the underpass to Clement's Inn will be shut off during this time. Alternative routes will be signposted and plans circulated.

### Fire Safety Work— Marshall Building

The scope of work includes the installation of a smoke extractor surrounding the atrium on L9 external terrace and a smoke door system spanning L3 to L7. The design has been carefully developed to maintain the building's original architectural intent, with meticulous attention to material selection. This project aims to further strengthen fire protection for the community.

The works are scheduled to take place **from 7 April to 24 September 2025**.

During this period, certain areas will have restricted access. The L6, L8, and L9 terraces will remain closed until project completion; however, the means of escape on the L8 terrace will remain accessible. Windows may be opened during warm weather.

A hoarding structure will be installed around the atrium below L2.

Crane operations are planned as part of the project, dates to be confirmed upon approval from Westminster Council. During these operations, access to the ground floor and basement level (bicycle storage) from Lincoln's Inn Fields will be temporarily closed.

### Asbestos Removal Works

We will be carrying out Asbestos removal works over the Easter period in Connaught House and St Clements. Unfortunately, due to the nature of these works there will be no access to the buildings during the dates and times shown below:

**Connaught House – Wednesday 16 April to Wednesday 23 April 2025 (out of hours working from 8pm to 4am),**

**St Clements – Monday 14 April to Thursday 24 April 2025 (out of hours working from 8pm to 4am),**

## Installation of Atrium Lift— Old Building

In order to improve the accessibility of Level 1 and 2 a new lift is being installed in the Student Services centre. This lift will enable wheelchair users to access Level 1 and 2. The works started in January 2025 and are due to **complete by June 2025**. An indicative illustration of the lift can be seen in this image.

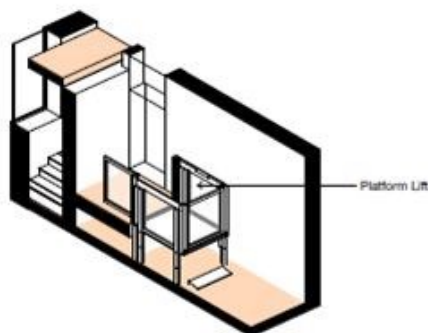

Vera Anstey Room Platform Lift



Atrium Lift in Student Services Centre

## Installation of Vera Anstey Room Platform Lift— Old Building

A new platform lift is also being installed to provide wheelchair access to the Vera Anstey Room on Level 1. The works started in January 2025 and will **complete by end April 2025**.

## Firoz Lalji Global Hub—update

The enabling works for The Firoz Lalji Hub are progressing and the majority of the demolition works have been completed. The new ground floor and building cores are currently being constructed with the aim to complete this first phase of works by Summer 2025. The main contract for the construction works will follow, with **completion planned for late Summer 2027**.

The new building is being constructed with sustainability at the heart of the design aiming to minimize embodied and operational carbon, maximise the reuse of existing material and energy efficiency.

The building will be occupied by the Firoz Lalji Africa Institute, Data Science Institute, Departments of Mathematics, Statistics and Executive and Extended Education.

Measures to minimize the noise and disruption to the surrounding buildings are being implemented by the contractor at source in accordance with statutory requirements and industry best practice.



## Student Salon—Kings Chambers

We will be carrying out refurbishment works within the Student Salon. We will be redecorating the space, providing additional microwaves & installing new furniture.

We are due commence works on **Monday 31st March 2025** with works due to be completed by the **end of May 2025**. We are currently looking to relocate the microwaves in SAW so that amenities are still available, this will be confirmed in due course.

## King's Chambers Finial project

The installation of the finial to the top of the lead dome on King's Chambers is planned to **start mid-May with completion in early June 2025**.

A scaffold will be erected to the corner of the building, there will be an element of noise within the area and the area will be cordoned off. There will be some disruption to building occupants as we will brace via the windows, communication to impacted occupants will be issued in due course.

## Café 54—CKK



We are working closely with Residential and Catering services to deliver a makeover of Cafe 54. Rebranded as K54, an exciting South-East Asian dining offer, supplementing the existing cafes in the area, such as the plant-based Shaw Café, Beavers Brew and the Bean Counter.

The works are expected to take place over **Spring/Summer 2025**. The exact dates will be communicated to the building occupiers and users as soon as the arrangements are finalised.

## Library turnstile replacement—Lionel Robbins Building

We will be replacing the existing turnstiles at the Library (LRB) entrance.

Works are due to commence in **early /mid July 2025 with completion expected to be in August**. During the duration of these works, the existing turnstiles will be cordoned off, and temporary arrangements will be made for the access and egress of the library, including providing access for wheelchair users.



## Public Sector Decarbonisation Scheme— Lionel Robbins Building

In February 2024, the LSE successfully obtained £2.7m in funding from the Public Sector Decarbonisation Scheme (PSDS) towards decarbonisation of the estate.

Together with match-funding from the LSE, the PSDS funding will be used to install new Air Source Heat Pumps (ASHPs) on the Lionel Robbins Building and remove the existing gas-fired boilers.



A contractor has been appointed and the project team are preparing to start on site in **mid-June 2025**. The works will continue throughout the Summer and Autumn, with target **completion in November**. To enable the works, the project team are preparing for a number of brief building shutdowns. This is due to the need to upgrade the UK Power Networks (UKPN) infrastructure serving the building. The project team are carefully planning and co-ordinating these with building users and stakeholders and more communications will be issued in due course.

**The first shutdown is planned for Saturday 5 April 2025 between approximately 7am and 12pm.**

## Volunteer Centre Refurbishment—Lincoln Chambers

The Volunteer Centre's mission is to inspire and empower the LSE community to volunteer for causes that they are passionate about, and the new refurbished space will highlight and showcase how students can contribute to the London community, and, in turn, how it will benefit them. We will be refurbishing to create a new reception desk, floor finishes & redecoration of the space along with new furniture.

**Works are due to be completed by April 2025.**



We appreciate that some of these works will cause inconvenience to staff and students but we have been working with affected stakeholders to ensure these are mitigated and kept to a minimum. These works will increase the quality and efficiency of our estate and your forbearance is much appreciated.

**Should you need any further information please don't hesitate to contact Cheryl Smitham, Assistant Director (Capital Development) on [C.Smitham1@lse.ac.uk](mailto:C.Smitham1@lse.ac.uk)**

**Steve Riddell, Interim Director of Capital Development, Estates Division**