

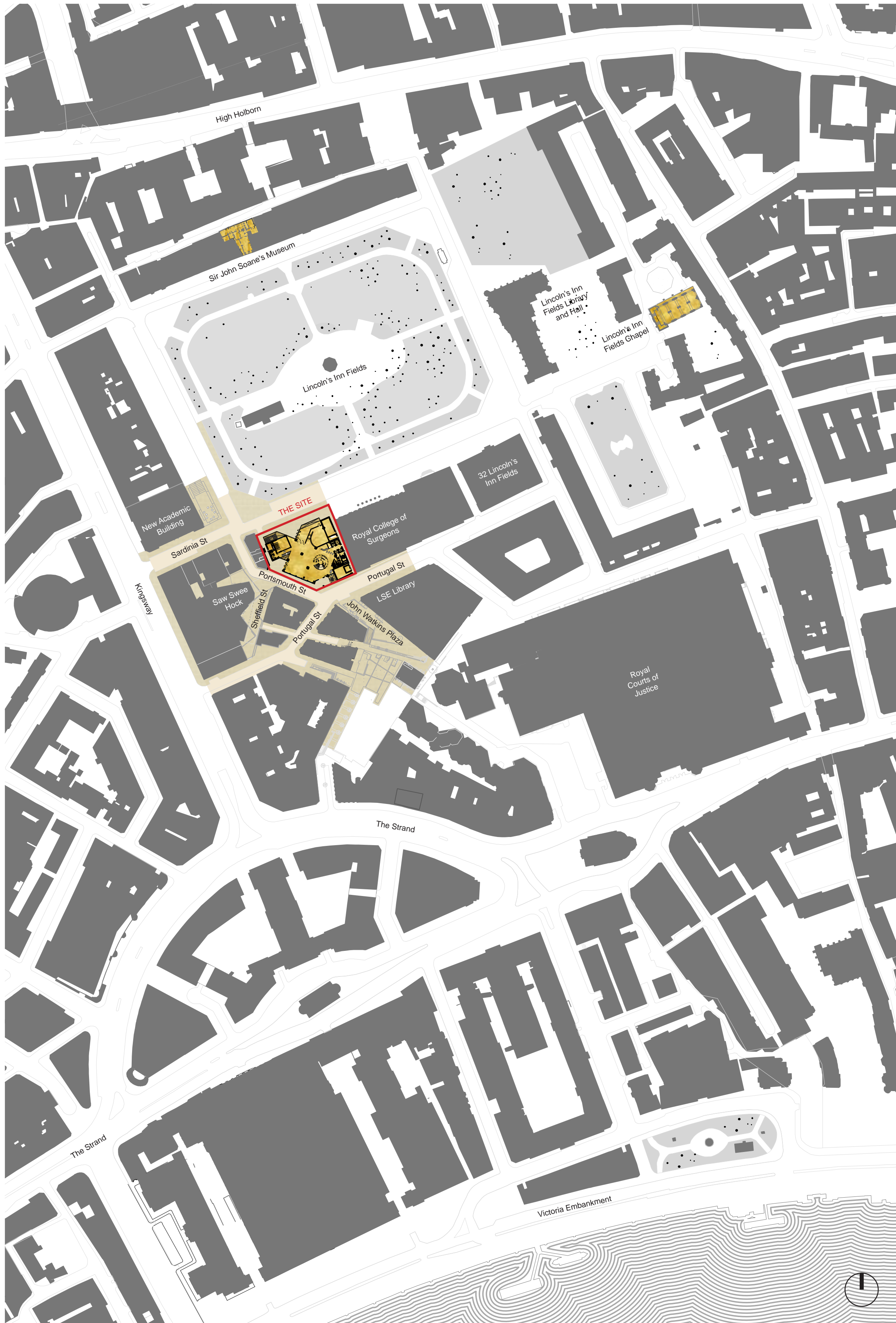

44 LINCOLN'S INN FIELDS
The Paul Marshall Building

LOCATION



Site plan - scale 1:2000

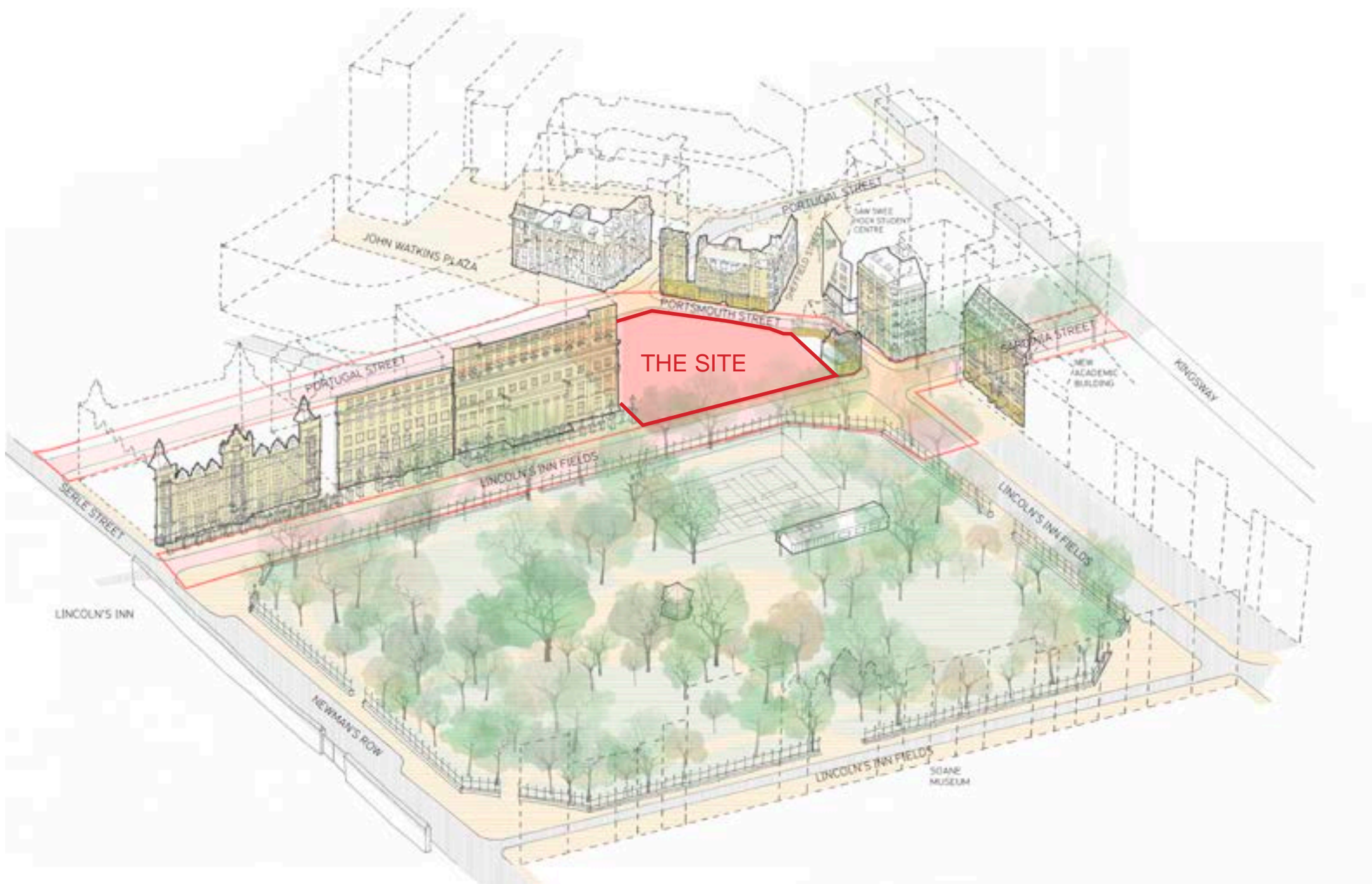

View of Lincoln's Inn Fields

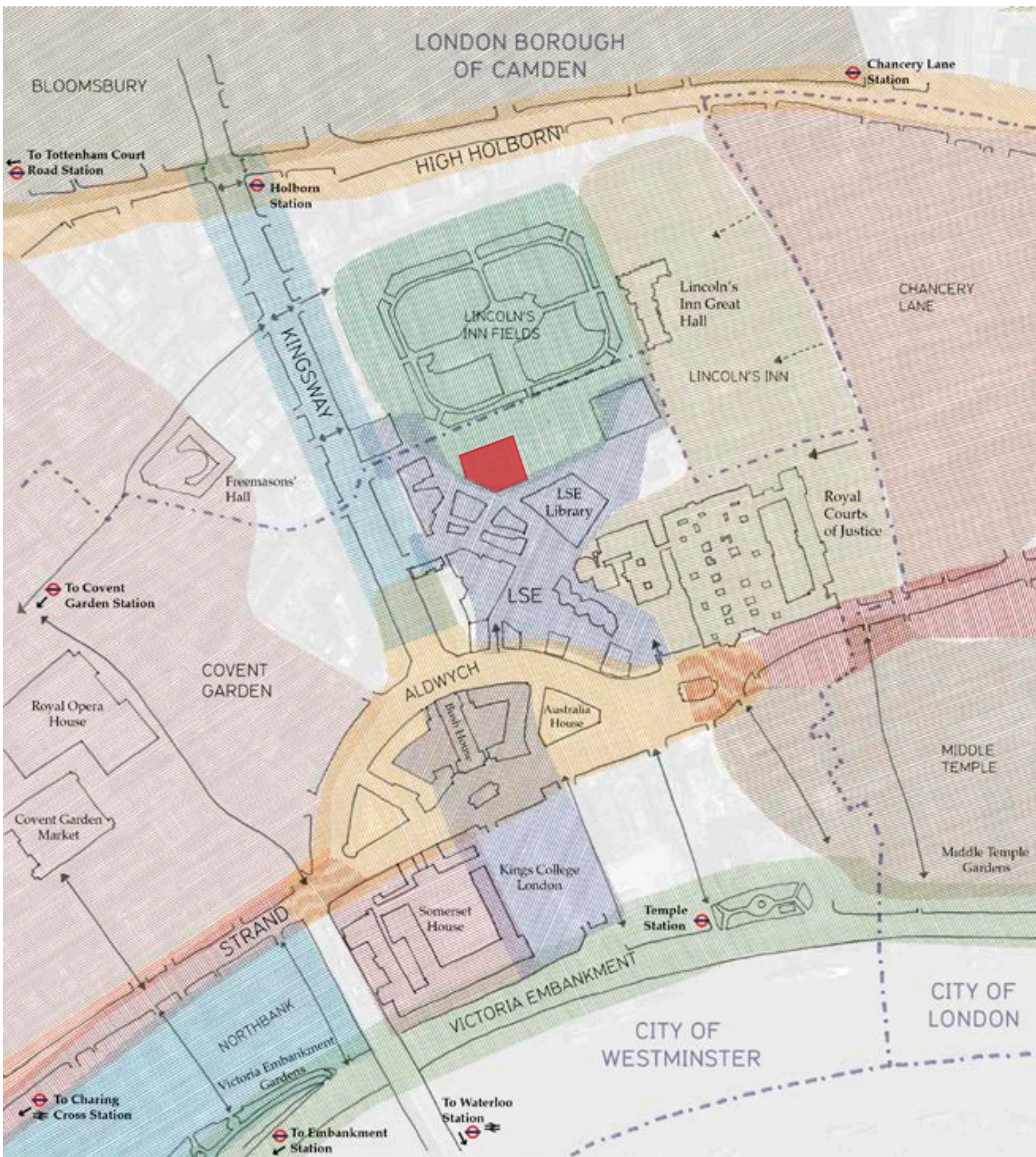

Map showing character areas surrounding the site and the LSE quarter

THE SITE AND ITS CONTEXT

LSE's ambition is for the Paul Marshall Building to be a welcoming, public-facing and highly sustainable building that contributes to the life of London. It will be located at an important corner of Lincoln's Inn Fields with the civic prominence to operate at a district wide scale and provide a gateway for the whole School.

Lincoln's Inn Fields has a unique status in London. It has an 'in-between' character being at the boundary of the three boroughs of Westminster, Camden and the City of London, i.e. the world of theatre-land, the lawyers world, and the informality of Camden.

The site of the Paul Marshall Building sits on the 'shoreline' of Lincoln's Inn Fields to the north and the intricate grain of LSE and the wider city to the south. It provides an opportunity to make a new internal and external urban landscape transforming connectivity between existing LSE buildings and Lincoln's Inn Fields.

Before-and-after aerial views on Lincoln's Inn Fields showing the existing and the proposal



graffon architects